

how to fit and care for your wood venetian blind

IN ORDER TO KEEP YOUR BLIND SAFE IN TRANSIT, THE BRACKETS ARE PACKED SEPARATELY AND ENCLOSED AT ONE END OF THE BOX. PLEASE CHECK THOROUGHLY BEFORE DISCARDING ANY PACKAGING.

aftercare

To ensure your Wood Venetian blind stays looking its best for many years to come, follow the straightforward operating and cleaning instructions below:

Operating Instructions

- One cord on the Wood Venetian operates the height of the blind
- The other cord operates the angle of the slats
- To raise the blind, pull the cord down until the blind reaches your desired height
- To lower the blind, pull the cord across the face of the blind to release the cordlock and let the cord slide through your fingers
- Pull the other cord to adjust the angle of the slats
- Slats should be in the open position when raising or lowering the blind

Cleaning

- Your Wood Venetian should only be cleaned with a dry lint-free cloth

WARNING

IN THE INTEREST OF SAFETY, PLEASE KEEP ALL PULL CORDS AND CHAINS OUT OF THE REACH OF CHILDREN. MOVE COTS, BEDS AND OTHER FURNITURE AWAY FROM BLINDS AND INSTALL SAFETY DEVICES SUCH AS CLEATS AND CORD TIDIES TO LIMIT ACCESS TO CORDS.

elements wood venetian blinds fitting instructions

fittings

1 End brackets (pair)

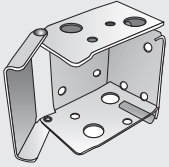

2 Matching fascia

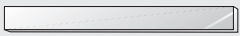

3 Fascia clips (pair)

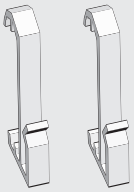

4 Centre support bracket (if length requires).

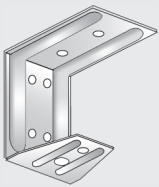

5 Screws: min 4

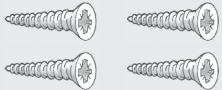

6 Rawl plugs: min 4

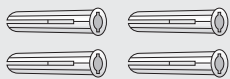

7 Blind: 1

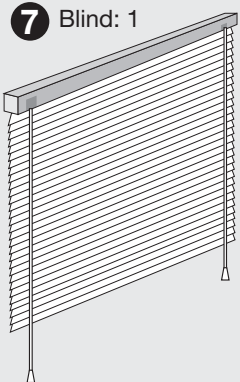

Outside Recess

If fitting the blind outside the window, measurements **(C)** will need to be the same. To work out **(C)**, simply minus **(B)** from **(A)** and divide the answer by two. Follow instructions for FACE FIXING

Inside recess

Decide whether to FACE or TOP FIX. FACE FIX to fit the bracket to the window frame. TOP FIX to the lintel if the window frame is uPVC, or if there are any obstructions, e.g. window handles.

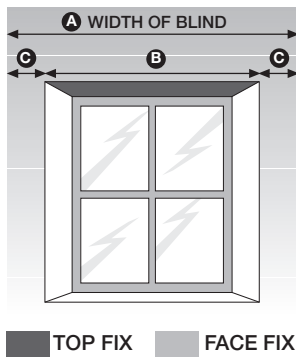

step one

Extend door hinge on each bracket as far as it will go.

Please note that the brackets can be used on either the left or the right, and the door is hinged on the side.

Position the bracket and mark two holes according to type of fixing chosen in Step 1.

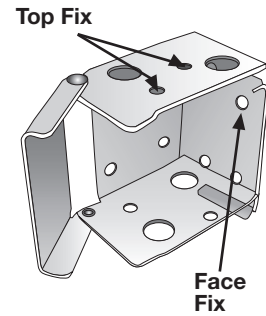

bracket for 35mm and 50mm blinds

step two

Once the brackets are fitted, remove plastic end caps from blind headrail. Slide the blind into the brackets, with velcro patches facing towards you.



step three

Push down and snap shut the hinge doors to lock the headrail into position.

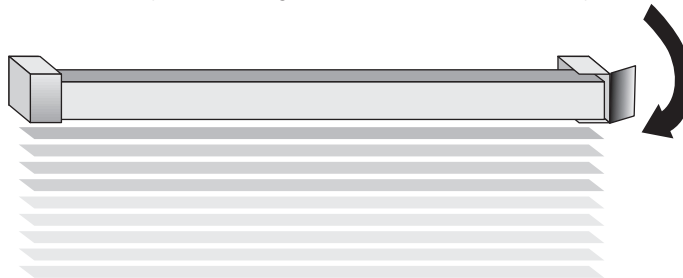

step four

Position fascia on front and attach to headrail with fascia clips.

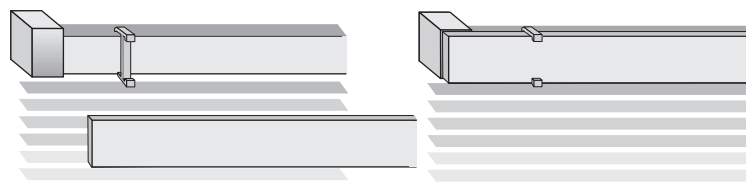

step five

Use right side cord controls to raise and lower the blind, pulling it to one side to lock into the desired position. Use the other cord controls to angle the louvres.

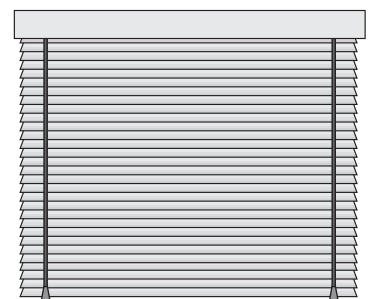

step six

WARNING

IN THE INTEREST OF SAFETY, PLEASE KEEP ALL PULL CORDS AND CHAINS OUT OF THE REACH OF CHILDREN. MOVE COTS, BEDS AND OTHER FURNITURE AWAY FROM BLINDS AND INSTALL SAFETY DEVICES SUCH AS CLEATS AND CORD TIDIES TO LIMIT ACCESS TO CORDS.